

Foothills

A landscape design for deer, fire and sloping yards

31'

26'

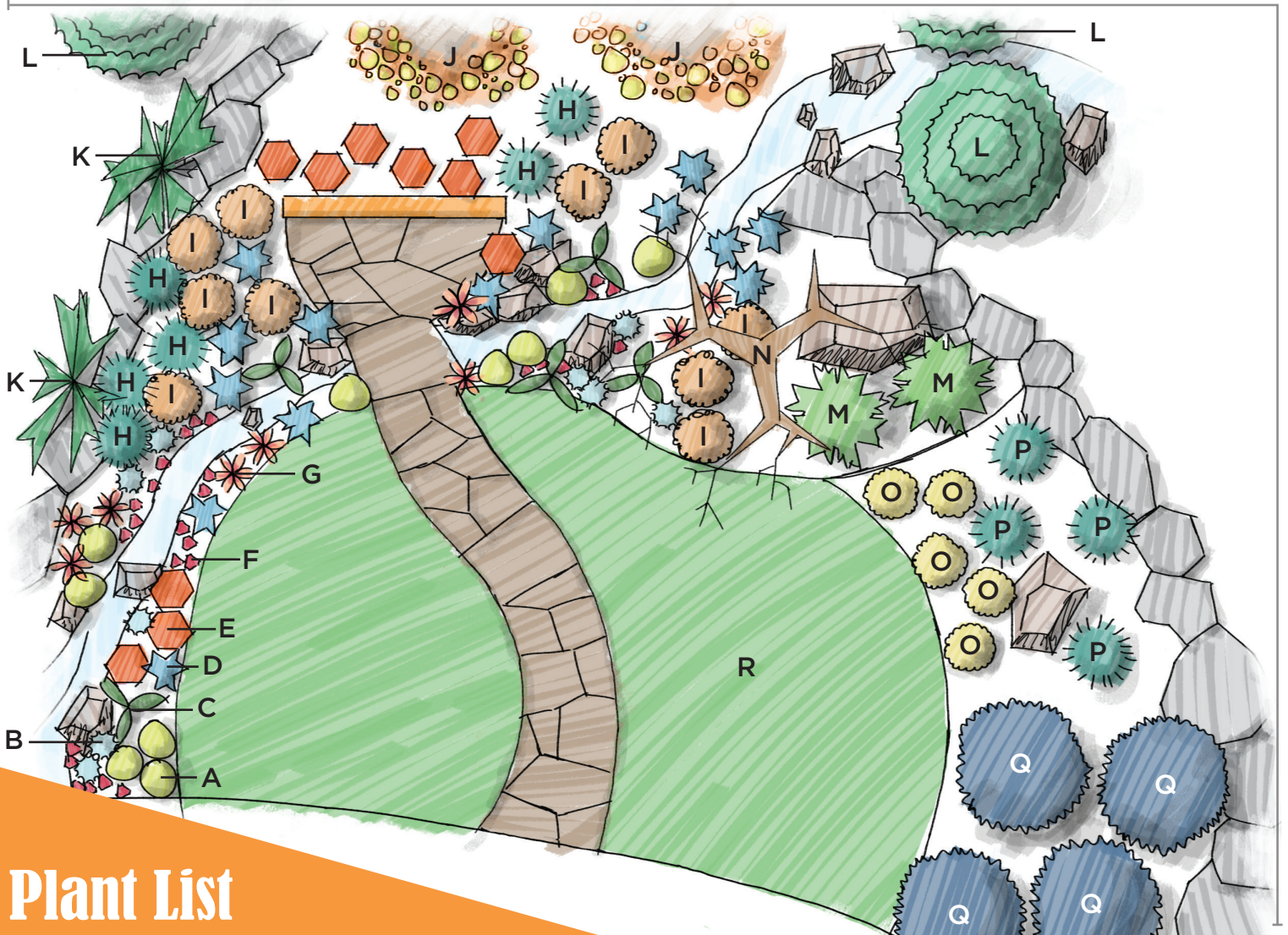

Plant List

- | | | |
|--------------------------------------|---|-------------------------------|
| A SULFUR FLOWER (10) | H BLONDE AMBITION BLUE GRAMA (6) | O MOONSHINE YARROW (5) |
| B BLUE FLAX (9) | I CORONADO HYSSOP (10) | P BLUE AVENA GRASS (4) |
| C GOLDEN SWORD YUCCA (5) | J YELLOW CURRANT (2) | Q BLUE MIST SPIREA (4) |
| D ROCKY MT. PENSTEMON (14) | K AUTUMN AMBER SUMAC (2) | R SHEEP FESCUE |
| E ORANGE GLOBE MALLOW (10) | L TALL BLUE RABBITBRUSH (3) | |
| F FIRE SPINNER ICE PLANT (27) | M VALLEY CUSHION MUGO PINE (2) | |
| G FRINGED SAGE (9) | N NEW MEXICO PRIVET (1) | |

Visit our garden at 2855 Mesa Rd. to see this landscape in person or check out csu.org for more information.

This water-wise landscape features deer-resistant plants and firewise principles. Grading and retaining walls direct water away from the home, irrigating some of the trees and shrubs. This type of landscape also works for properties adjacent to open space that need to transition from landscaped areas to nature.

Foothills landscape tips:

- Incorporate native plants to transition seamlessly between your landscape and adjacent natural areas. Check out csu.org for a list of low-water plants that deer are less likely to browse.
- On a sloped site, install retaining walls to create flatter areas that are easier to plant and water.
- A dry streambed can be constructed to direct water away from your home's foundation toward trees and shrubs.
- Use boulders to generate visual interest and highlight plants.
- Blending plants, rather than using sharp edges, will create a more natural look.



Colorado Springs Utilities

It's how we're all connected

csu.org



Sheep Fescue



Fringed Sage



Kannah Creek Sulfur Flower



Coronado Hyssop

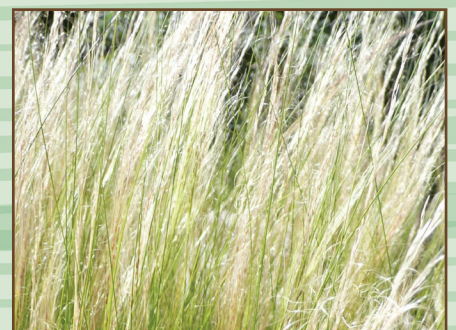

Mexican Feather Grass